

Tuesday, September 15, 2020

LOCATION

| | |
|-------------------------|--|
| Property Address | Sawyer Brown Rd Nashville, TN 37221 |
| Subdivision | |
| County | Davidson County, TN |

PROPERTY SUMMARY

| | |
|-------------------------|-------------------------|
| Property Type | Residential |
| Land Use | Vacant Residential Land |
| Improvement Type | |
| Square Feet | |

GENERAL PARCEL INFORMATION

| | |
|-----------------------------|-----------------|
| Parcel ID/Tax ID | 114-00-0-252.00 |
| Alternate Parcel ID | |
| Account Number | |
| District/Ward | GSD |
| 2010 Census Trct/Blk | 183.01/3 |
| Assessor Roll Year | 2020 |

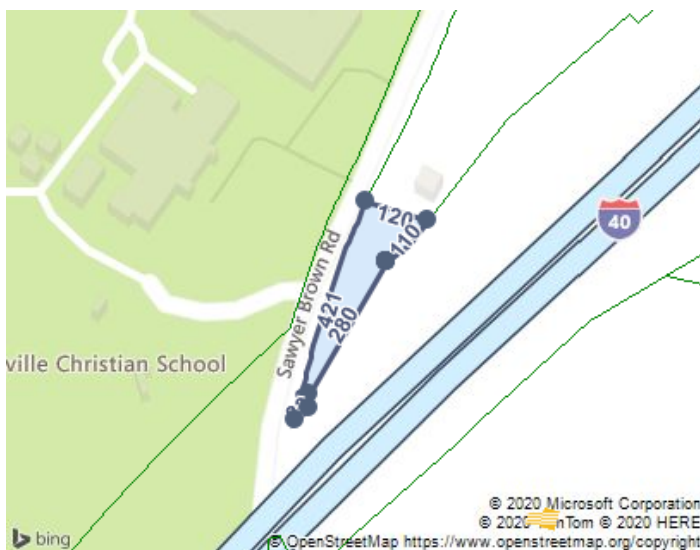

CURRENT OWNER

| | |
|------------------------|--|
| Name | Buttrely Mary E |
| Mailing Address | 7620 Sawyer Brown Rd Nashville, TN 37221-1205 |

SALES HISTORY THROUGH 09/09/2020

| Date | Amount | Buyer/Owners | Seller | Instrument | No. Parcels | Book/Page Or Document# |
|-----------|--------|--------------------|--------|--------------------------|-------------|------------------------|
| 1/13/1996 | | Buttrely Mary E | | Affidavit | 2 | 200604110041394 |
| 11/2/1995 | | Buttrely Randall | | Family Sale Or Will Book | 2 | 201311220120352 |
| 9/17/1991 | | Buttrely Ideline I | | Dt | 2 | 1432/558 |

TAX ASSESSMENT

| Appraisal | Amount | Assessment | Amount | Jurisdiction | Rate |
|-------------------------------|---------|------------------------------|--------|----------------------------------|-------|
| Appraisal Year | 2019 | Assessment Year | 2019 | | |
| Appraised Land | \$1,500 | Assessed Land | \$375 | General Services District | 2.755 |
| Appraised Improvements | | Assessed Improvements | | | |
| Total Tax Appraisal | \$1,500 | Total Assessment | \$375 | | |
| | | Exempt Amount | | | |
| | | Exempt Reason | | | |

TAXES

| Tax Year | City Taxes | County Taxes | Total Taxes |
|----------|------------|--------------|-------------|
| 2019 | | \$10.33 | \$10.33 |
| 2018 | | \$10.33 | \$10.33 |
| 2017 | | \$10.33 | \$10.33 |
| 2016 | | \$14.72 | \$14.72 |
| 2015 | | \$14.72 | \$14.72 |

| | | |
|------|---------|---------|
| 2014 | \$14.72 | \$14.72 |
| 2013 | \$14.72 | \$14.72 |

MORTGAGE HISTORY

No mortgages were found for this parcel.

PROPERTY CHARACTERISTICS: BUILDING

No Buildings were found for this parcel.

PROPERTY CHARACTERISTICS: EXTRA FEATURES

No extra features were found for this parcel.

PROPERTY CHARACTERISTICS: LOT

| | | | |
|---------------------------|-------------------------|------------------------|-----------|
| Land Use | Vacant Residential Land | Lot Dimensions | 440 X 110 |
| Block/Lot | | Lot Square Feet | 24,394 |
| Latitude/Longitude | 36.106188°/-86.930709° | Acreage | 0.56 |

PROPERTY CHARACTERISTICS: UTILITIES/AREA

| | | | |
|------------------------|---|----------------------------------|--|
| Gas Source | | Road Type | |
| Electric Source | | Topography | |
| Water Source | | District Trend | |
| Sewer Source | | Special School District 1 | |
| Zoning Code | R15: One And Two Family - (15,000 Square Foot Lot) | Special School District 2 | |
| Owner Type | | | |

LEGAL DESCRIPTION

| | | | |
|--------------------|--|-----------------------|-----|
| Subdivision | | Plat Book/Page | |
| Block/Lot | | District/Ward | GSD |
| Description | N E Corner Sawyer Brown Rd & I-40 / Neighborhood Code And Name: 6736 Blivue Manor/1776 Est/Westchase | | |

FEMA FLOOD ZONES

| Zone Code | Flood Risk | BFE | Description | FIRM Panel ID | FIRM Panel Eff. Date |
|-----------|------------|-----|--|---------------|----------------------|
| X | Minimal | | Area of minimal flood hazard, usually depicted on FIRMs as above the 500-year flood level. | 47037C0331H | 04/05/2017 |