

# Soils Map

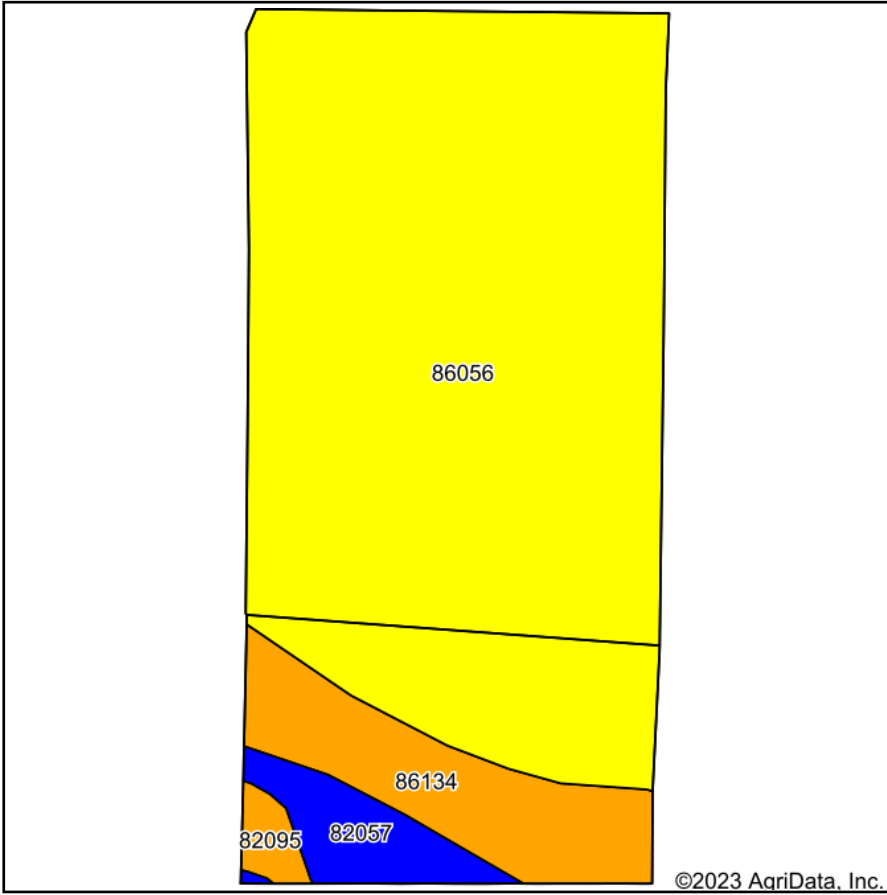

Soils data provided by USDA and NRCS.

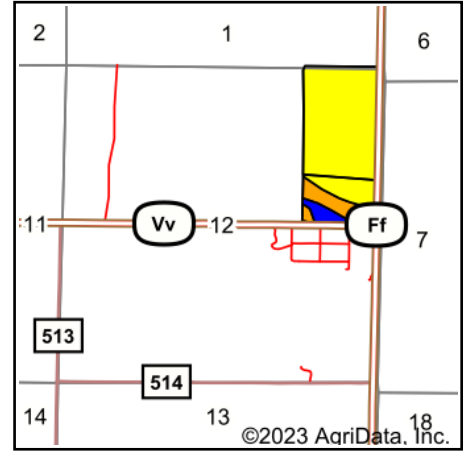

State: **Missouri**  
 County: **Mississippi**  
 Location: **12-24N-16E**  
 Township: **Wolf Island**  
 Acres: **75.55**  
 Date: **1/3/2023**



Maps Provided By:



© AgriData, Inc. 2021

www.AgriDataInc.com



Area Symbol: MO133, Soil Area Version: 23

Code	Soil Description	Acres	Percent of field	Non-Irr Class Legend	Non-Irr Class *c	Alfalfa hay Tons	Caucasian bluestem Tons	Common bermudagrass Tons	Corn Bu	Corn Irrigated Bu	Cotton lint Lbs	Cotton lint Irrigated Lbs	Grain sorghum Bu	Orchardgrass red clover Tons	Rice Irrigated Bu
86056	Sharkey silty clay, 0 to 1 percent slopes, occasionally flooded	62.58	82.8%		IVw				8		600	840			7
86134	Tunica silty clay loam, 0 to 1 percent slopes, occasionally flooded	8.48	11.2%		IIIw				7		540	756	8		6
82057	Towosahgy fine sandy loam, 0 to 1 percent slopes	3.49	4.6%		IIIs	6	9		8	3	697	929	4		7
82095	Malden fine sand, 1 to 5 percent slopes, rarely flooded	1.00	1.3%		IIIs	2	3		4		480	720			3
<b>Weighted Average</b>						<b>3.78</b>	<b>0.3</b>	<b>0.5</b>	<b>7.8</b>	<b>0.1</b>	<b>0.2</b>	<b>596.2</b>	<b>833.1</b>	<b>1.1</b>	<b>6.8</b>

\*c: Using Capabilities Class Dominant Condition Aggregation Method  
 Soils data provided by USDA and NRCS.