

LAND Auction

SATURDAY
June 10, 2023 @ 10 AM

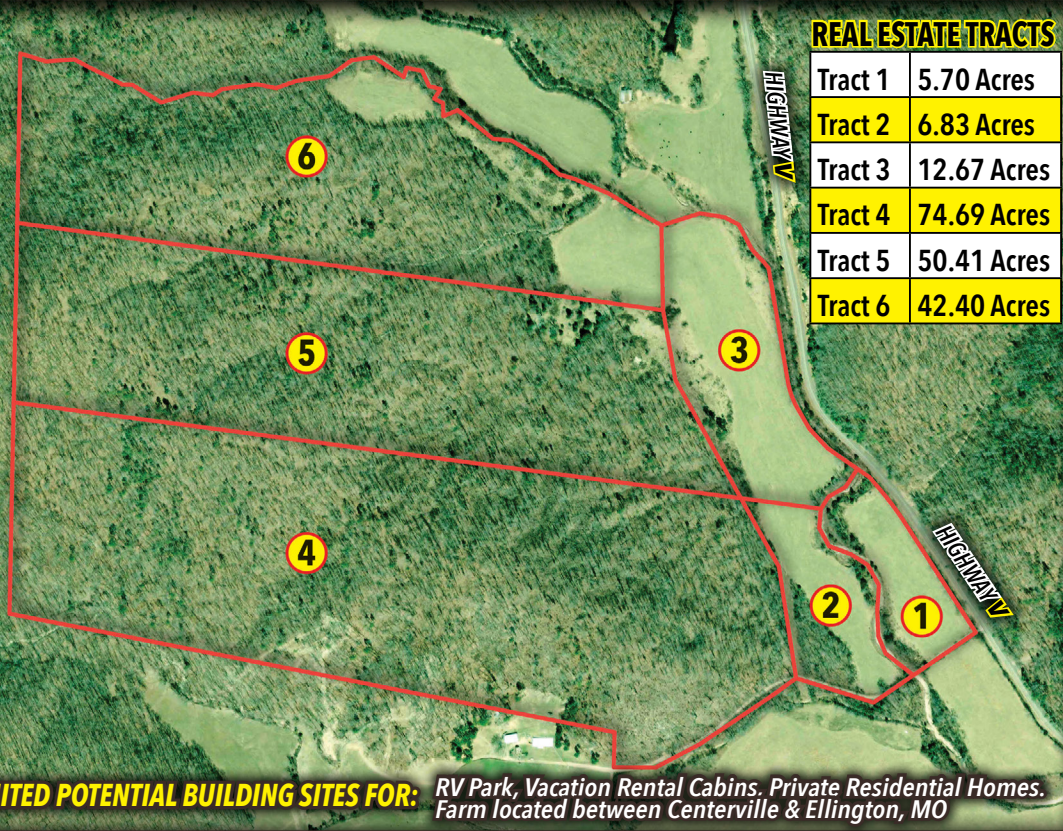

REAL ESTATE TRACTS

Tract 1	5.70 Acres
Tract 2	6.83 Acres
Tract 3	12.67 Acres
Tract 4	74.69 Acres
Tract 5	50.41 Acres
Tract 6	42.40 Acres

192± ACRES

in 6 Tracts & Combinations!

FARM LOCATION:
HIGHWAY V
REDFORD, MO

CRUISE THE TIMBER
EXCELLENT BUILDING SITES
22± TILLABLE ACRES
HUNTING

BID
LIVE OR @ harrisauctions.com
ONLINE

UNLIMITED POTENTIAL BUILDING SITES FOR: RV Park, Vacation Rental Cabins. Private Residential Homes.
Farm located between Centerville & Ellington, MO

AUCTION HELD AT: Ellington City Hall-Community Room **AT 10:00 AM** 100 TUBBS AVENUE, ELLINGTON MO 63638

800.380.4318 | harrisauctions.com | premierfarmrealtygroup.com

LAND Auction



192±
ACRES

in 6 Tracts & Combinations!



This property is minutes away from one of the many Black River floating access points and Suttons Bluff recreation area in Mark Twain's National Forest. It is 120 miles to St. Louis and Sikeston.



REAL ESTATE TERMS: A 10% Buyer's Premium will be added to the final bid and included in the deed transaction sale price. DOWN PAYMENT: 15% as down payment on the day of the auction with balance in cash at closing on or before 30 days. The down payment may be in the form of cashier's check, personal check, or corporate check. YOUR BIDDING IS NOT CONDITIONAL UPON FINANCING, SO BE SURE YOU HAVE ARRANGED FINANCING, IF NEEDED, AND ARE CAPABLE OF PAYING CASH AT CLOSING. CLOSING: Closing shall take place on or before 30 days from auction date. REAL ESTATE TAXES: All 2023 ad valorem taxes will be prorated at closing. ANNOUNCEMENTS MADE BY THE AUCTION COMPANY AT THE AUCTION PODIUM DURING THE TIME OF THE SALE WILL TAKE PRECEDENCE OVER ANY PREVIOUSLY PRINTED MATERIAL, OR ANY OTHER ORAL STATEMENTS MADE.

Harris Real Estate & Auction
3855 State Route 45 North
Mayfield, KY 42066

FIRST CLASS MAIL
PRESORT
U.S. POSTAGE
PAID
MAYFIELD, KY 42066
PERMIT NO. 25

800.380.4318 | harrisauctions.com | premierfarmrealtygroup.com

HARRIS
Real Estate & Auction

MICHAEL HARRIS
PRINCIPAL BROKER
AUCTIONEER
Licensed in Missouri - County Issued
270.247.3253

In Partnership with:

PREMIER FARM
REALTY GROUP & AUCTION

DALE DUNN
President & Founder / Broker
Premier Farm Realty Group, LLC
dale@pfrgrp.com
636.443.9481