

Lynn Grove Community

SATURDAY FEBRUARY 3, 2024 @ 10 AM

PROPERTY LOCATED: 198 J W WILLIAMS LANE, MURRAY KY 42071

LAND AUCTION

**Highly Tillable Acres!
Great Building Sites!**

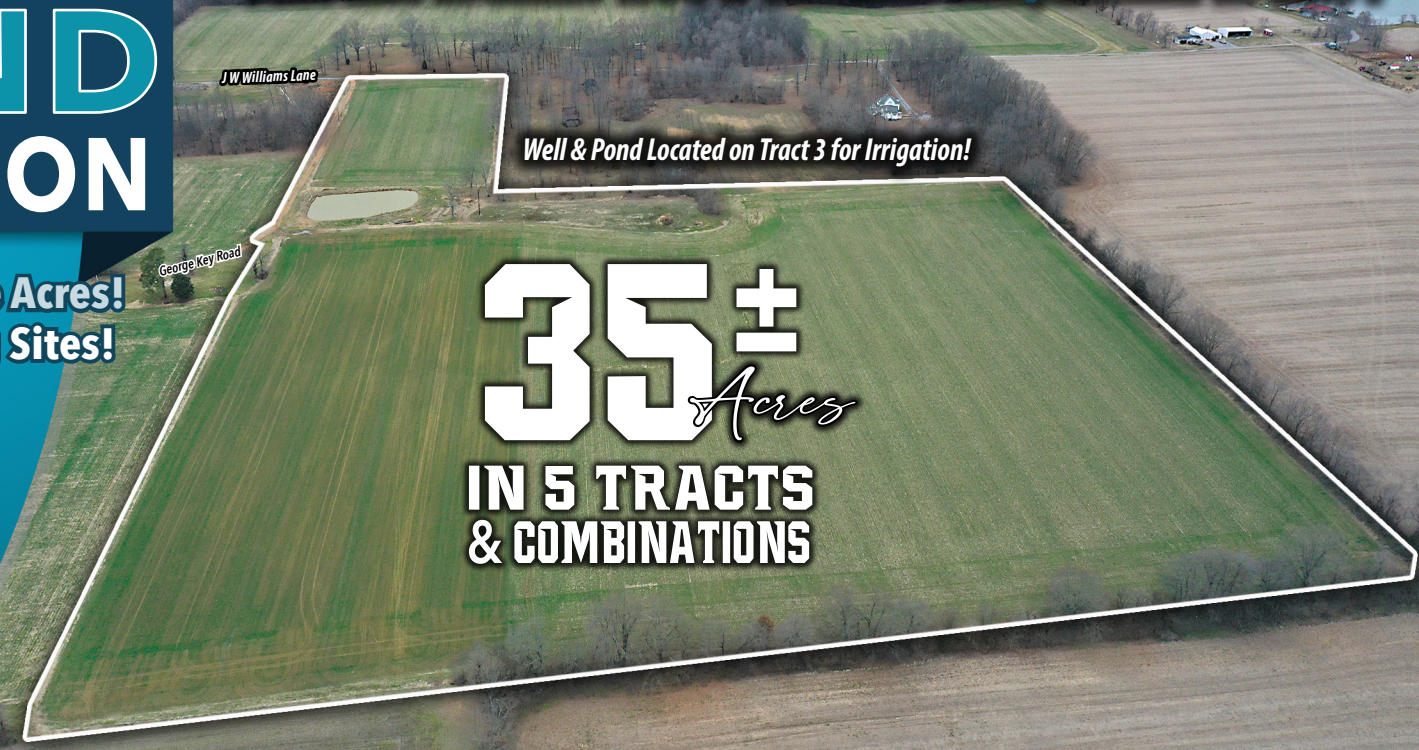

J W Williams Lane

George Key Road

Well & Pond Located on Tract 3 for Irrigation!

35± *Acres*

IN 5 TRACTS & COMBINATIONS



AUCTION HELD LIVE & ONLINE

**270-247-3253
harrisauctions.com**



**10:00 AM at
THE GROVE OF MURRAY
1300 N 16th Street
Murray, KY 42071**

LAND AUCTION

Lynn Grove Community

35±
Acres

Well & Pond Located on Tract 3 for Irrigation!

TRACT 3

Highly Tillable Acres! Great Building Sites!

IN 5 TRACTS & COMBINATIONS

Real Estate Tracts

Tract 1	2.87 Acres
Tract 2	2.11 Acres
Tract 3	10.71 Acres
Tract 4	9.58 Acres
Tract 5	9.56 Acres

JVM Williams Lane

Map Legend

30' WIDE EASEMENT FOR EGRESS/INGRESS TO TRACTS 1, 2, 3, 4 & 5

MICHAEL HARRIS
PRINCIPAL BROKER / PRINCIPAL AUCTIONEER
KL# 252972 | KY Broker# 198374



SATURDAY FEBRUARY 3, 2024 @ 10 AM
at THE GROVE OF MURRAY
1300 N 16th St, Murray, KY 42071

REAL ESTATE TERMS: A 10% Buyer's Premium will be added to the final bid and included in the deed transaction sale price.

DOWN PAYMENT: 15% as down payment on the day of the auction with balance in cash at closing on or before 30 days. The down payment may be in the form of cashier's check, personal check, or corporate check. **YOUR BIDDING IS NOT CONDITIONAL UPON FINANCING, SO BE SURE YOU HAVE ARRANGED FINANCING, IF NEEDED, AND ARE CAPABLE OF PAYING CASH AT CLOSING.**

SURVEY: The property will be sold by a new survey. BUYER will be responsible for 50% of the survey costs.

CLOSING: Closing shall take place on or before 30 days from auction date.

ANNOUNCEMENTS MADE BY THE AUCTION COMPANY AT THE AUCTION PODIUM DURING THE TIME OF THE SALE WILL TAKE PRECEDENCE OVER ANY PREVIOUSLY PRINTED MATERIAL, OR ANY OTHER ORAL STATEMENTS MADE.

The images shown are for illustration purposes ONLY and may not be an exact representation.

270-247-3253 / harrisauctions.com



Harris Real Estate & Auction

3855 State Route 45 North
Mayfield, KY 42066